



ECHELON

DIAMOND SERIES

PIZZA OVEN



RHP CONNECT APP Setup & Operation

GETTING STARTED

VERIFY COMPATIBILITY

The app and touch-controlled digital thermometer/thermostat is offered with select Fire Magic Pizza Ovens, and is compatible with select electronic devices. See Table 1 and Table 2.

Product	Model
Echelon Diamond Pizza Oven equipped w/ under glass digital thermostat control	5660(P)

Table 1 - Appliance Compatibility

Electronic Device Operating System Requirements
iOS 11.0 or higher
Android v10.0 or higher

Table 2 - Electronic Device Requirements

INSTALL PIZZA OVEN

If not already done, follow the instruction manual provided with your pizza oven for proper installation.

Then proceed to the following APP SETUP section.

DOWNLOAD AND INSTALL RHP CONNECT APP

Visit <https://www.firemagicgrills.com/digital-touch-control/> or simply scan the QR code on the right.



Before setting up, ensure the RHP CONNECT app is downloaded and installed. Visit <https://www.firemagicgrills.com/digital-touch-control/> to download.

CREATE AN ACCOUNT

Note: This app setup process must be repeated for each device in the household that will be used for operation. To download and install the "RHP Connect" app, scan the QR code on the previous page, visit the link above, or search for "RHP Connect" in your app store (see Fig. 2-1 for app logo). Then follow the prompts on your screen to create an account. See Fig. 2-2 through Fig. 2-4 for details.

- You will receive an e-mail with a confirmation code; please check junk/spam folders in case the e-mail gets blocked.
- For select devices, you can sign in using external platforms such as Google or Facebook.



Fig. 2-1
Download RHP Connect

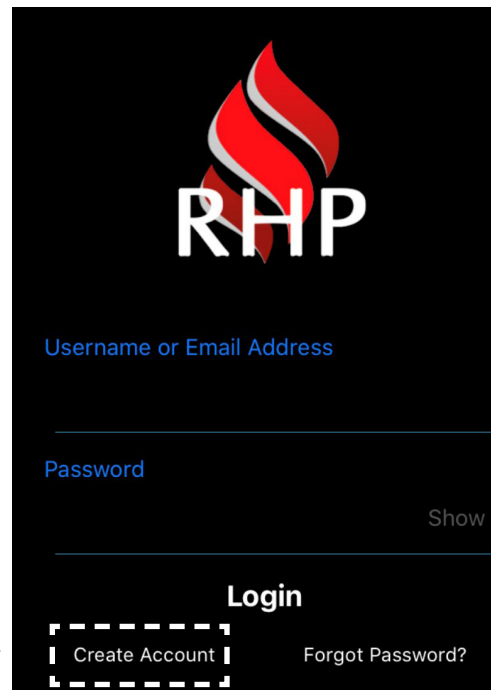

Fig. 2-2 Select create account / sign up

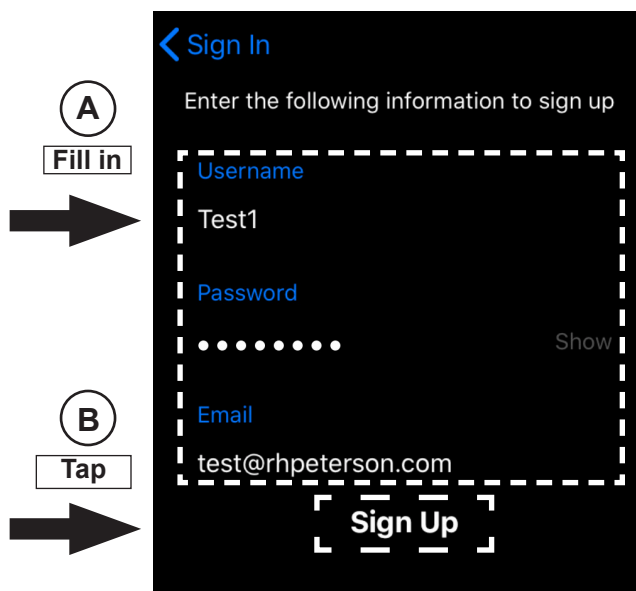

Fig. 2-3 Fill out screen and sign up

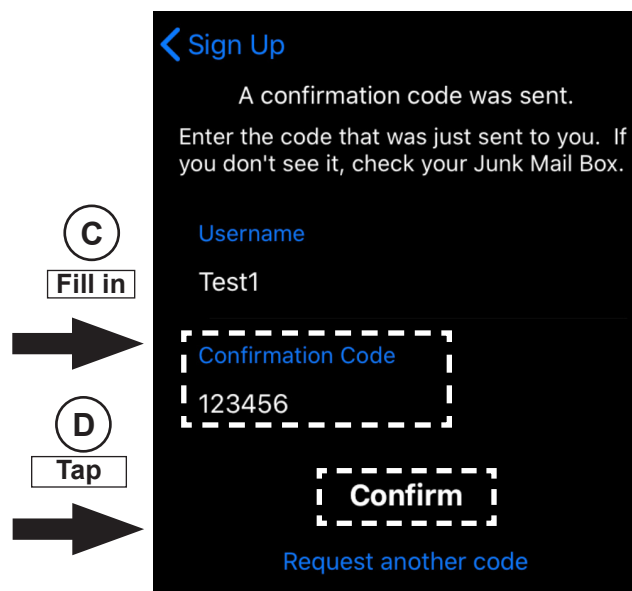

Fig. 2-4 Confirm sign up

APP SETUP (Cont.)

CREATE AN INITIAL ZONE

Once your account is created, proceed to the "Zones" screen, and if needed tap the ⊕ icon to enter the "New Zone" screen as shown below. Fill in the "Enter Location" field. The other fields will auto-fill. Then tap "Save Zone". Proceed by tapping on the newly created zone. See Fig. 3-1, Fig. 3-2 and Fig. 3-3 for details.

Note: It is recommended you allow RHP Connect to access your location for full functionality of the app.

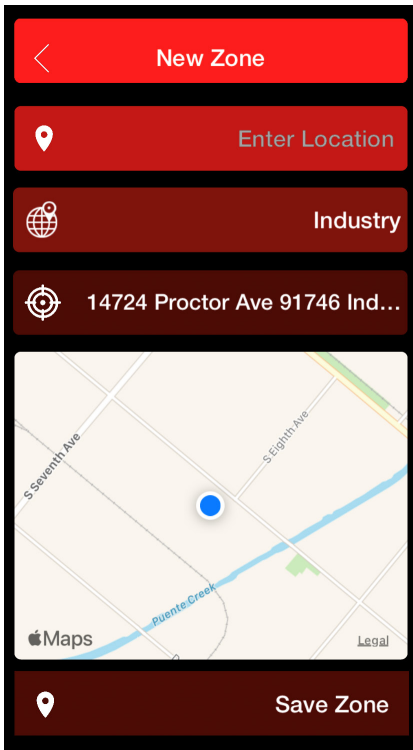

Fig. 3-1 Create zone

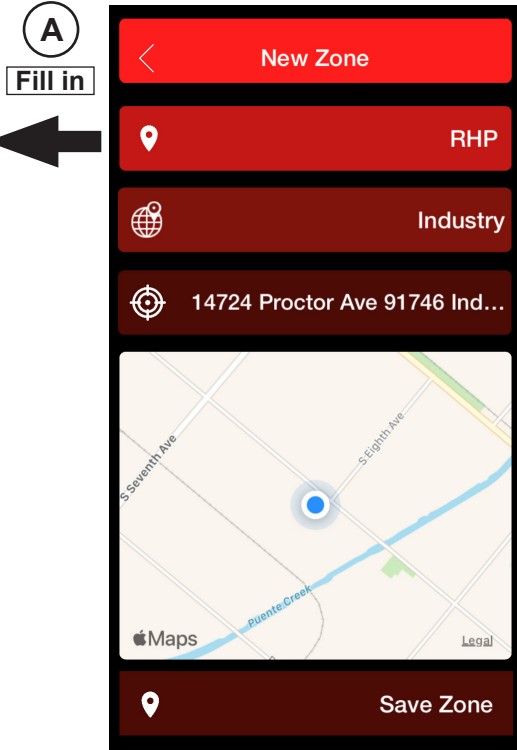

Fig. 3-2 Save zone

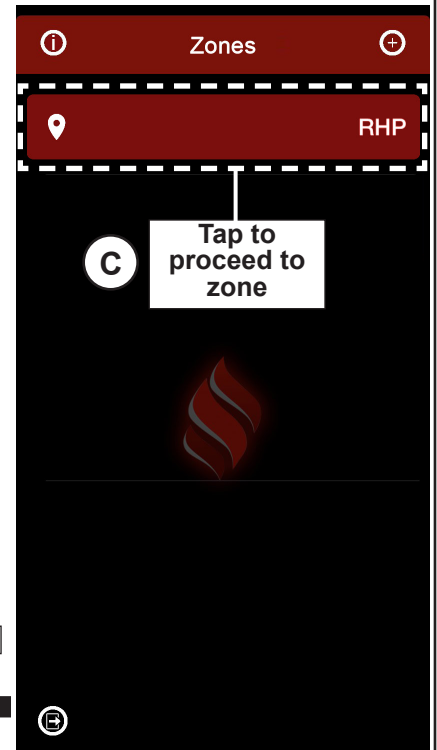

Fig. 3-3 Proceed to zone

APP SETUP (Cont.)

ADD YOUR DEVICE

1. Press the **THERMOMETER POWER SWITCH** on the pizza oven control panel (See Fig. 4-1). The digital display will illuminate.
2. Hold your device up against the digital display screen (See Fig. 4-2), then follow the prompts to pair the pizza oven to the app.
3. Fill in the fields as needed. Then tap "**Connect**". See Fig. 4-3 and Fig. 4-4.
4. Tap on your pizza oven under the "Devices" screen (see Fig. 4-5). The app will proceed to pizza oven operating default screen.

Your app is now ready to control the pizza oven. Proceed to the APP OPERATING INSTRUCTIONS section.

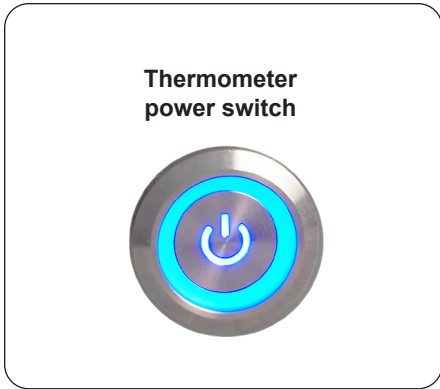

Fig. 4-1 Turn on Thermometer



Fig. 4-2 Tap device against grill display screen



Fig. 4-3 Add your device

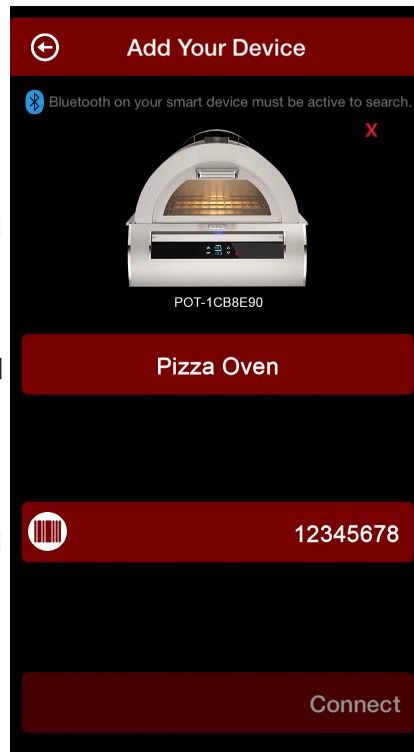

Fig. 4-4 Confirm connection

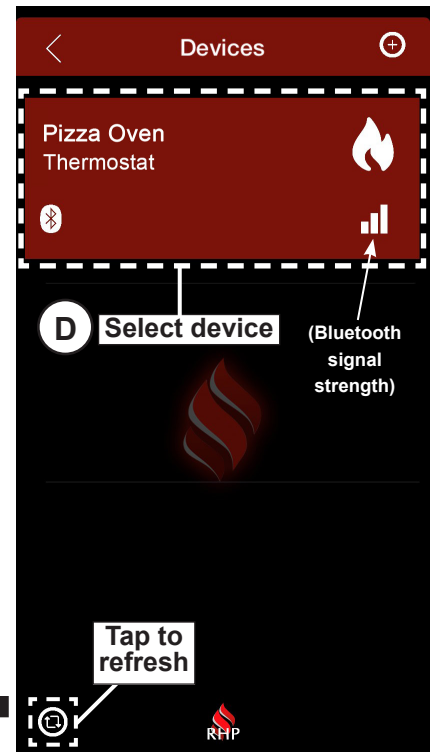

Fig. 4-5 Select device

OPERATING INSTRUCTIONS

BEFORE USE

Ensure that the pizza oven is properly installed, the power supply cord is plugged in, the power source is turned on, the RHP connect app is setup on your electronic device, and your pizza oven digital controls are successfully paired with the RHP CONNECT app.

Ensure that you have read all instructions completely and carefully prior to product use. Refer to them as needed.

Note: The digital controls on the pizza oven are bluetooth and wifi enabled. Bluetooth has a max range operation of up to 30 feet (range may vary between device model/version). To extend the range of operation, the device can be connected to wifi. See the CONNECT TO WIFI section to setup.

Note: When using Bluetooth, the unit can be controlled by only one electronic device at a time, whereas connecting via wifi enables two devices to simultaneously operate the unit.

For best user experience and to update thermometer/thermostat firmware version, it is recommended to connect the thermometer/thermostat to wifi. See the CONNECT TO WIFI section for details.

FOR YOUR SAFETY, READ BEFORE USING THE PIZZA OVEN

WARNING: IF YOU DO NOT FOLLOW THESE INSTRUCTIONS AND ALL INFORMATION FOUND IN THE SAFETY / WARNING CODES, AND IMPORTANT SAFEGUARDS SECTIONS OF THE PIZZA OVEN OWNER'S MANUAL, A FIRE MAY RESULT, CAUSING PROPERTY DAMAGE, PERSONAL INJURY, OR LOSS OF LIFE.

Operation continued on next page

OPERATING INSTRUCTIONS (cont.)

For complete details regarding the digital controls featured on the pizza oven, see the pizza oven owner's manual.

POWER ON PIZZA OVEN AND DIGITAL CONTROLS

To control the pizza oven via the app, it must first be **manually** turned on. The pizza oven thermometer power switch is located on the right side of the control panel.

1. Press the **thermometer power switch** (see Fig. 6-1). The display will turn on and remain in "standby mode".
2. Press and hold the **TIMER** button (on the pizza oven display) until the remainder of the display illuminates. See Fig. 6-2, A. This activates the thermometer/thermostat.
3. Now that the thermometer/thermostat is turned on, **THE BURNERS WILL IGNITE** and the temp readings will display on the app. See Fig. 6-2, B and Fig. 6-3.

WARNING: The burner ON/OFF status must be verified in person - it is an attended appliance. The **red LED status light** (see Fig. 6-2) indicates that the burners are on.

- The unit automatically begins to preheat to the default temperature of 450° F. To set your desired temperature, see the SET OVEN TEMPERATURE section below.
- The readings on the app update every 5 seconds.

POWER OFF PIZZA OVEN DIGITAL CONTROLS

Press the **Off** button on the app to turn off the heat and thermometer/thermostat (see Fig. 6-3). The controls will remain inactive and the display will switch to "standby mode", and the burners will turn off (see Fig. 6-1).

The **thermometer power button** on the pizza oven's control panel **MUST** be switched to the **OFF** position when not in use.

Note: The Off button on the app WILL NOT turn ON power to the thermometer/thermostat. It must be manually turned on via the pizza oven by pressing and holding the **TIMER** button. See the section above and Fig. 6-1 to turn on.

SET OVEN TEMPERATURE

Set the oven temperature by tapping on the **Oven** display reading. Input in the desired temperature, then tap **Done**.

- The oven display will climb until it reaches the set temperature. Once reached, a notification will display on the screen, the device will vibrate and ring, and the pizza oven controls will start flashing and the alarm will sound. Follow the prompts on the screen to silence.
- The displayed set temperature remains unchanged regardless of the actual temperature. Even with frequent door opening, varying environmental conditions, or the addition of cold food causing temperature fluctuations, the set temperature will remain as the target temperature until you manually set a new one or if there's a 100°F difference between the set temperature and the actual ambient temperature.

Thermometer power switch



(Under glass digital display)



(Only these icons will be illuminated when in standby mode)

Fig. 6-1 Turn on pizza oven

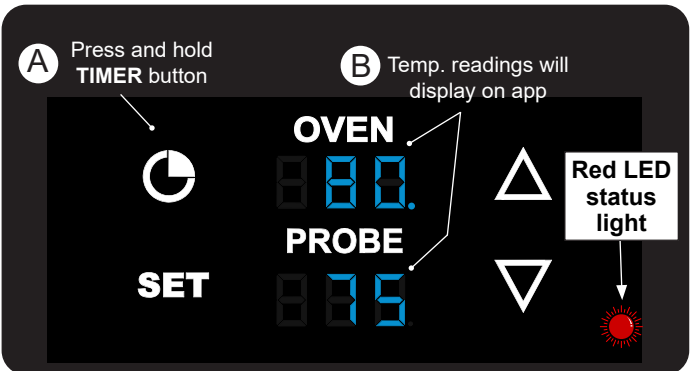

Fig. 6-2 Power ON thermometer/thermostat

Tap to input your desired temperature

Press to turn OFF heat and digital controls on grill.

Note: This button does not turn ON the heat and digital controls. As a safety measure, it must be manually turned on using the grill's controls.

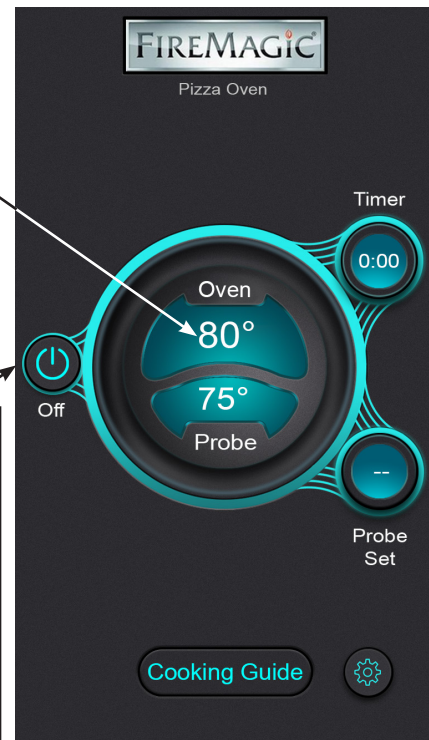

Fig. 6-3 Temp readings on app

SETTING THE TIMER

Set the timer by tapping on the **Timer** display. Input the desired time, then tap **OK** (see Fig. 7-1).

- The timer will start and the count down will show on the Timer display.
- The timer displays in the format of Minutes:Seconds (00:00). See Fig. 7-1.
- Once the timer reaches zero, a notification will display on the screen, the device will vibrate and ring (if set on your device), and the pizza oven controls will start flashing and the alarm will sound. Follow the prompts on the screen to silence.
- The timer can be set at a maximum of two hours.

MEAT PROBE

Note: The probe display grays-out when the meat probe is not connected (see Fig. 7-1).

The probe jack is on the right side of the control panel. Connect the meat probe to the probe jack. The probe temperature will display. At this point, the meat probe can be inserted into the meat for temperature monitoring.

For complete details about your meat probe, see the pizza oven owner's manual under the DIGITAL THERMOMETER / THERMOSTAT section.

To set the meat probe temp/alarm:

Tap on the **Probe Set** display and input your desired temperature (see Fig. 7-2). Tap **Done** to confirm. The target temp will be shown on the probe set display.

- The probe is calibrated specifically for use at temperatures between 125°F and 180°F. Do not set the probe outside of those parameters.



Fig. 7-1 Tap timer to set



Fig. 7-2 Tap probe set to set probe temp

COOKING GUIDE

The cooking guide serves as a convenient point of reference during cooking, and when the meat probe is connected, you may choose a temperature from the cooking guide and it will set it to the meat probe temp/alarm.

1. From the default screen, tap on **Cooking Guide**.
2. Tap on the desired temperature, then tap **OK** to confirm. See Fig. 8-1.

CONNECT TO WIFI

Connecting the app to a wifi network (2.4 GHz only) will extend the range for a better cooking experience. Before setting up wifi, ensure your electronic device is already connected to the wifi network.

Important: Ensure your pizza oven is within range of the wifi signal.

1. From the default screen, tap on the **Settings** icon.
2. Verify the wifi name displaying in the app is correct.
3. Type in the wifi password. If needed, clear out the dots before typing in the password.
4. Tap **OK**. It will exit the settings screen and go back to the default screen. A prompt reading "WiFi Setup Successful" will display. See Fig. 8-2.

Note: It is possible that the thermometer on the pizza oven may reboot after successfully connecting to wifi.

Note: If the *incorrect* wifi name is displayed, tap on the incorrect wifi name and select the correct wifi name from the list of available networks, input the password, then tap **OK**.

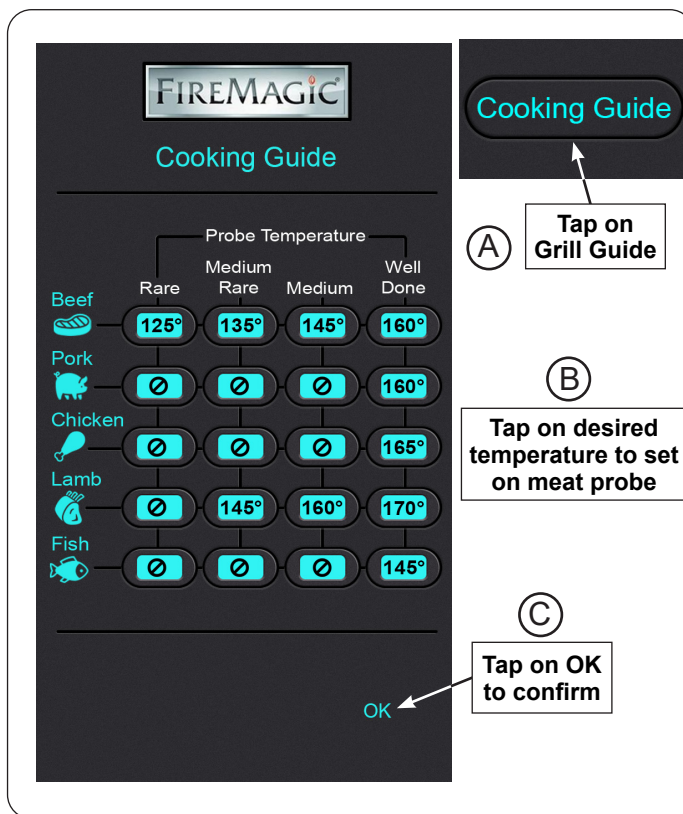

Fig. 8-1 Cooking guide

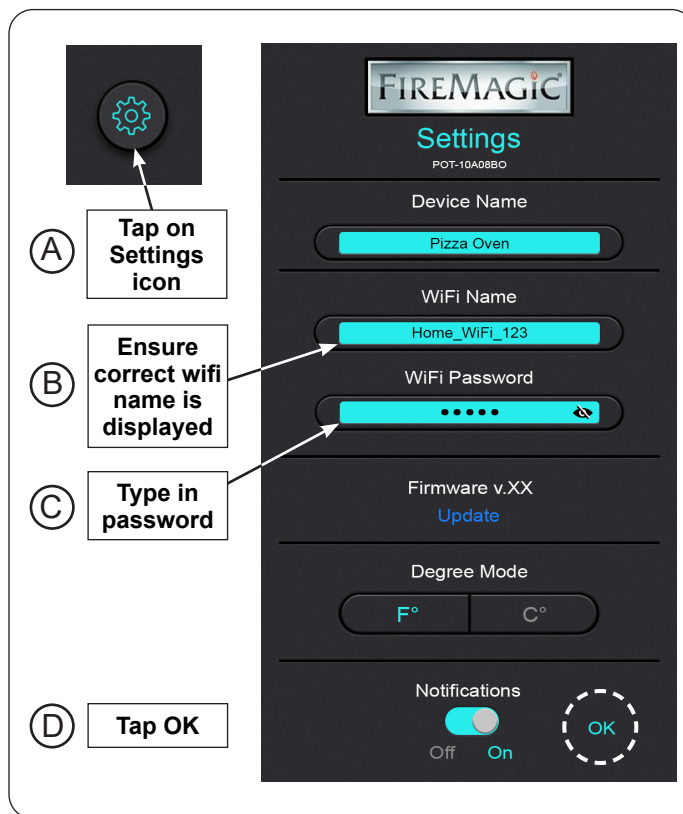

Fig. 8-2 Wifi setup

OPERATING INSTRUCTIONS (cont.)

CHANGE DEGREE MODE (F°/C°)

1. From the default screen, tap on the **Settings** icon.
2. Under Degree Mode, select **F°** or **C°**, then tap **OK** to confirm. See Fig. 9-1.

NOTIFICATIONS

1. From the default screen, tap on the **Settings** icon.
2. Tap on the Notifications toggle switch to turn notifications **on** or **off**, then tap **OK** to confirm. See Fig. 9-1.

Note: Notifications may vary between device models and/or notification settings on the device's operating system.

Note: If solely operating via bluetooth, the screen on the electronic device must remain on (disable screen timeout settings on device) at all times while cooking to receive all notifications.

FIRMWARE UPDATE

1. Ensure:
 - the thermometer power switch on the pizza oven is turned on (leave unit in "standby mode" - burners are off)
 - the pizza oven is connected to the app
 - the app and appliance is connected to wifi (must be connected to wifi for update to work, see **CONNECT TO WIFI** section to setup)
 - the pizza oven and electronic device have a strong wifi signal
2. Once all the above are confirmed, from the default screen tap on the Settings icon.
3. Under Firmware, tap on "Update". See Fig. 9-2.

Note: If "update" button is not visible, the firmware version is up to date or wifi is not connected.

ADDITIONAL SETTINGS

- The device ID number is for tech support reference.
- To rename your device name, tap on the device name, type in new name, then tap **Done**.

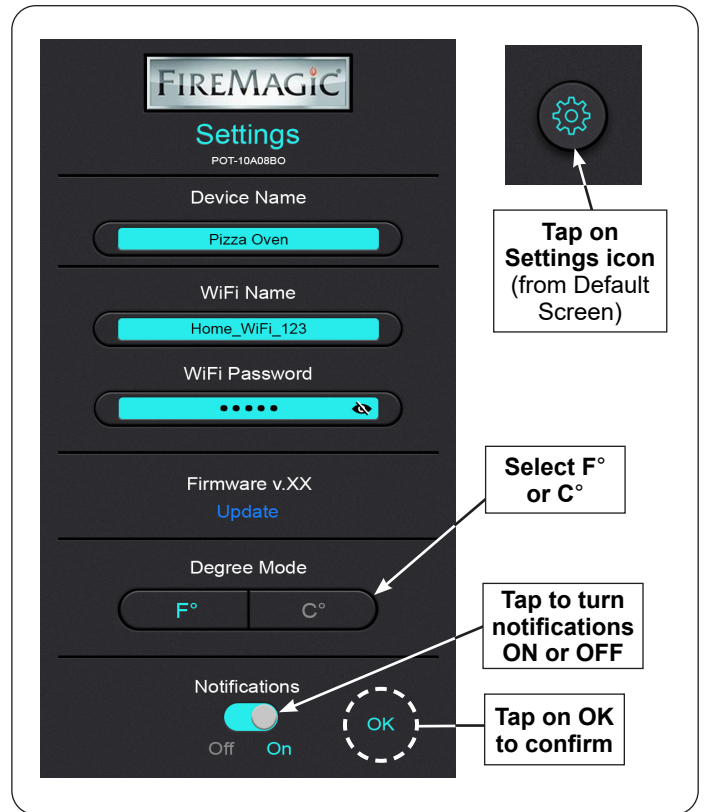

Fig. 9-1 Degree Mode & Notifications



Fig. 9-2 Degree Mode & Notifications

INSTRUCTIONS D'UTILISATION

AVANT UTILISATION

Assurez-vous que le four à pizza est correctement installé, que le cordon d'alimentation est branché, que la source d'alimentation est allumée, que l'application RHP Connect est configurée sur votre appareil électronique, et que les commandes numériques de votre four à pizza sont correctement associées à l'application RHP Connect.

Assurez-vous d'avoir lu toutes les instructions attentivement et intégralement avant d'utiliser le produit. Référez-vous à elles au besoin.

Note: Les commandes numériques du four à pizza sont dotées de la technologie Bluetooth et Wifi. Le Bluetooth a une portée maximale d'environ 30 pieds (la portée peut varier selon le modèle/version de l'appareil). Pour étendre la portée de fonctionnement, l'appareil peut être connecté au Wifi. Consultez la section "CONNECTER AU WIFI" pour la configuration.

Note: Lors de l'utilisation du Bluetooth, l'unité ne peut être contrôlée que par un seul appareil électronique à la fois, tandis que la connexion via le Wi-Fi permet à deux appareils de fonctionner simultanément sur l'unité.

POUR VOTRE SÉCURITÉ, LIRE AVANT D'UTILISER LE FOUR À PIZZA

AVERTISSEMENT: SI VOUS NE SUIVEZ PAS CES INSTRUCTIONS ET TOUTES LES INFORMATIONS TROUVÉES DANS LES CODES DE SÉCURITÉ / D'AVERTISSEMENT ET LES SECTIONS DES GARANTIES IMPORTANTES DU MANUEL DU PROPRIÉTAIRE DU FOUR À PIZZA, UN INCENDIE PEUT SE PRODUIRE, ENTRAÎNANT DES DOMMAGES MATÉRIELS, DES BLESSURES PERSONNELLES OU UN DÉCÈS.

Pour obtenir tous les détails concernant les commandes numériques présentes sur le four à pizza, veuillez consulter le manuel du propriétaire du four à pizza.

ALLUMEZ LE FOUR À PIZZA ET LES COMMANDES NUMÉRIQUES

Pour contrôler le four à pizza via l'application, il doit d'abord être allumé manuellement. L'interrupteur d'alimentation du thermomètre du four à pizza se trouve sur le côté droit du panneau de contrôle.

1. Appuyez sur l'**interrupteur d'alimentation du thermomètre** (voir Fig. 10-1). L'affichage s'allumera et restera en mode "veille".
2. Appuyez et maintenez enfoncé le bouton de la **MINUTERIE** (sur l'affichage du four à pizza) jusqu'à ce que le reste de l'affichage s'illumine. Voir Fig. 10-2, A. Cela active le thermomètre/thermostat.
3. Maintenant que le thermomètre/thermostat est allumé, **les BRÛLEURS vont S'ALLUMER** et les températures s'afficheront sur l'application. Voir Fig. 10-2, B et Fig. 10-3.

AVERTISSEMENT: L'état de marche/arrêt du brûleur doit être vérifié en personne - c'est un appareil surveillé. **Le voyant d'état rouge LED** (voir Fig. 10-2) indique que les brûleurs sont allumés.

- L'unité commence automatiquement à préchauffer à la température par défaut de 450°F (232°C). Pour régler la température souhaitée, consultez la section RÉGLER LA TEMPÉRATURE DU FOUR ci-dessous.

RÉGLER LA TEMPÉRATURE DU FOUR

Réglez la température du four en tapant sur l'affichage du **oven**. Entrez la température souhaitée, puis appuyez sur **Done**.

- L'affichage du four va monter jusqu'à atteindre la température définie. Une fois atteinte, une notification s'affichera à l'écran, l'appareil vibrera et sonnera, et les commandes du four à pizza se mettront à clignoter tandis que l'alarme retentira. Suivez les instructions à l'écran pour la désactiver.
- La température de consigne affichée reste inchangée quelle que soit la température réelle. Même en ouvrant fréquemment la porte., de conditions environnementales changeantes ou d'ajout d'aliments froids provoquant des fluctuations de température, la température de consigne restera la température cible jusqu'à ce que vous en régliez une nouvelle manuellement ou si elle diffère de 100°F par rapport à la température ambiante réelle.

D'alimentation du thermomètre



(Affichage numérique sous verre)

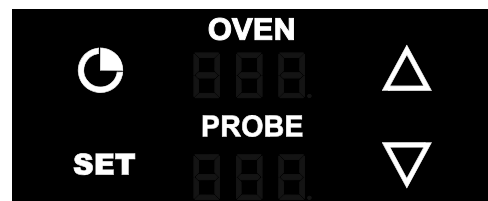

(Seuls ces icônes seront illuminés en mode veille)

Fig. 10-1 Allumer le gril électrique

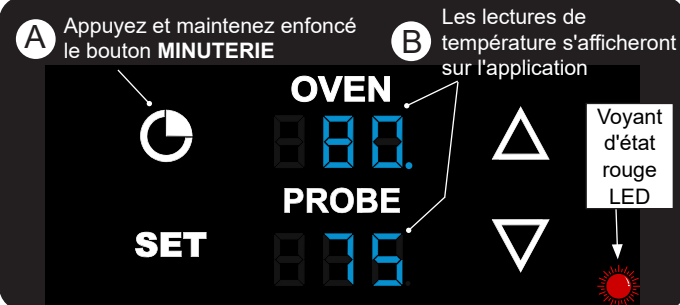

Fig. 10-2 Allumer le thermomètre/thermostat



Fig. 10-3 Températures affichées sur l'application

OPERATING INSTRUCTIONS (Cont.)

ADDING, EDITING, DELETING A NEW ZONE OR DEVICE

- To add a new zone or device, tap the ⊕ icon found on the top right of your screen (see Fig. 11-1 or Fig. 11-2).
- To delete a zone or device, slide your finger across the desired unit, and tap "Delete" (see Fig. 11-1 or Fig. 11-2).
- To edit an existing zone, slide your finger across the desired zone, and tap "Edit" (see Fig. 11-1).

LOGGING OUT

To log out, simply click on the **Logout** icon and then tap **Yes** (see Fig. 11-3). To prevent unwanted use, it is recommended to log out after device is turned off.

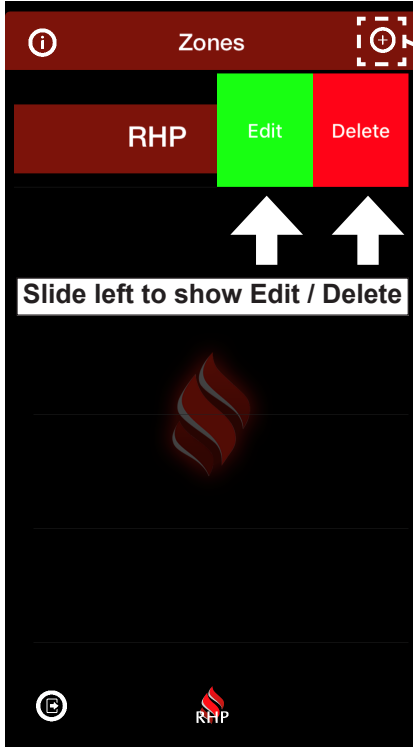

Fig. 11-1 Add/Edit/Delete Zone

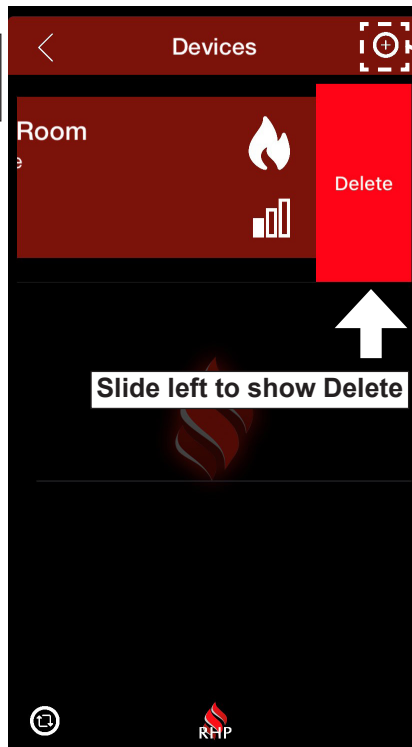

Fig. 11-2 Add/Delete Device

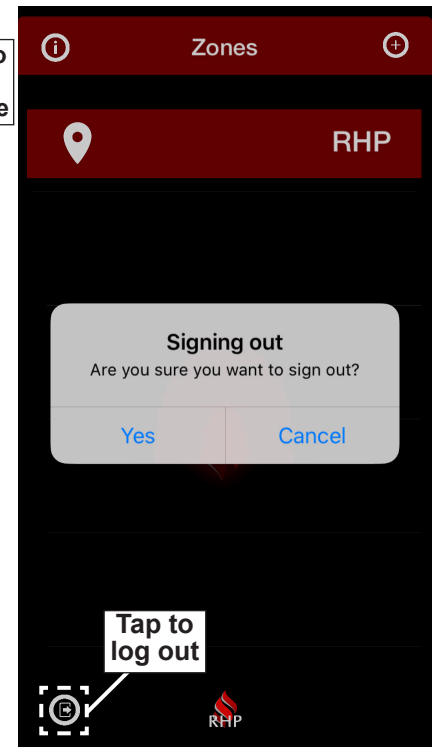

Fig. 11-3 Logging out

FORGOT PASSWORD

Select "**Forgot password**" on the home screen. Then follow the prompts on your screen to update your password. See Fig. 11-2 through Fig. 11-4 for details.

- You will receive an e-mail with a confirmation code; please check junk/spam folders in case the e-mail gets blocked.

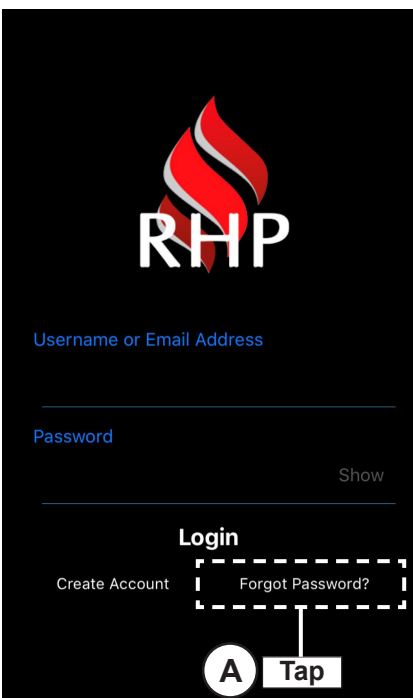

Fig. 11-2 Select forgot password

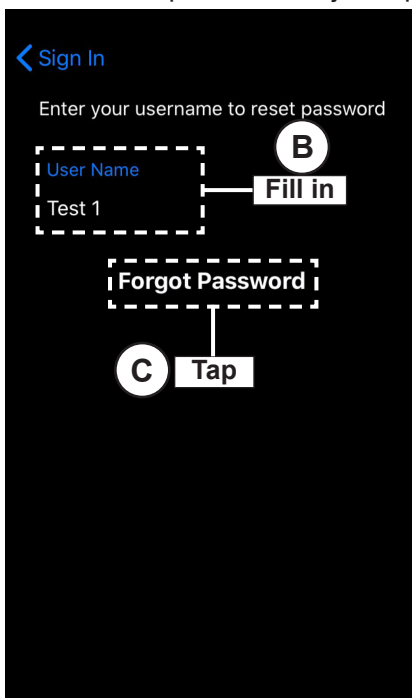

Fig. 11-3 Fill out screen

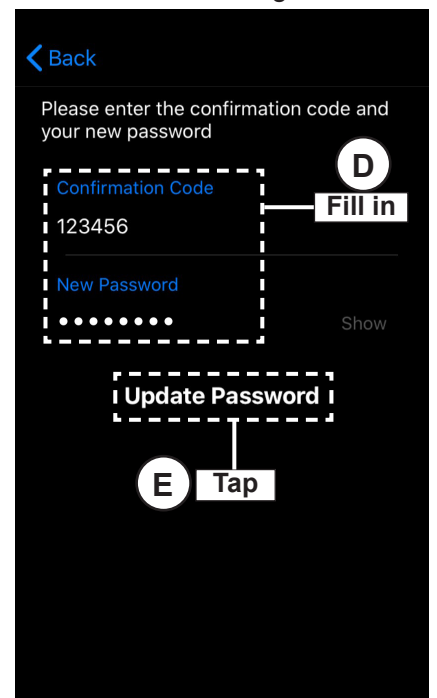

Fig. 11-4 Update password

TROUBLESHOOTING

If you are having trouble while using the app, see below to identify the problem.

PROBLEM	POSSIBLE CAUSE	CORRECTION
Digital display does not work	<ol style="list-style-type: none"> 1. Thermometer power switch not on 2. Electronic device out of range of pizza oven 3. App not paired with pizza oven 4. Faulty thermometer/thermostat control 5. Power failure 6. Power not connected properly 	<ol style="list-style-type: none"> 1. Ensure thermometer power switch on control panel is on (and light is illuminated). 2. Ensure device is within 30 feet (bluetooth) or within the wifi signal range. 3. Pair device. Refer to the ADD YOUR DEVICE section for details. 4. Check/replace thermometer/thermostat control. 5. Check if power is available. 6. Make sure the power source and powering equipment is properly connected and tested.
Digital display does not respond to electronic device	<ol style="list-style-type: none"> 1. App not paired with pizza oven 2. App update needed 3. Thermometer/thermostat firmware update needed 4. Electronic device out of range of pizza oven 5. Bluetooth or wifi disconnected 6. Unable to use the app 7. Faulty thermometer/thermostat control 	<ol style="list-style-type: none"> 1. Pair device. Refer to ADD YOUR DEVICE section for details. 2. Check in the app store for any updates and follow the prompts. 3. Update firmware via the app. Refer to the FIRMWARE UPDATE section for details. 4. Ensure device is within 30 feet (bluetooth) or within the wifi signal range (if setup to wifi). 5. Reconnect bluetooth or wifi on your electronic device. 6. If you are unable to operate the pizza oven using the app, turn off the pizza oven by pressing the thermometer power switch or you may continue to operate the pizza oven manually using the oven touch controls. Reinstall the app or call support. 7. Check/replace thermometer/thermostat control.
Error code: Err	<ol style="list-style-type: none"> 1. Thermocouple failure 	<ol style="list-style-type: none"> 1. Thermocouple disconnected or faulty. Check connection or replace if faulty.

TECHNICAL APP ISSUES

If you need assistance on a technical issue related to the app (log in, connectivity, etc.), please e-mail the app support department support@app-assist.com or call (833) 437-8783. You may also tap on the support icon from the Zones screen (see Fig. 12-1) to call support directly from the app.

ELECTRIC GRILL ISSUES

If you are having trouble with the operation of the pizza oven, see the TROUBLESHOOTING section of the manual included with your pizza oven.

If the information on this page does not resolve your issue, please contact your local dealer, e-mail our general support department: support@rhpeterson.com, or visit our web site at www.rhpeterson.com.

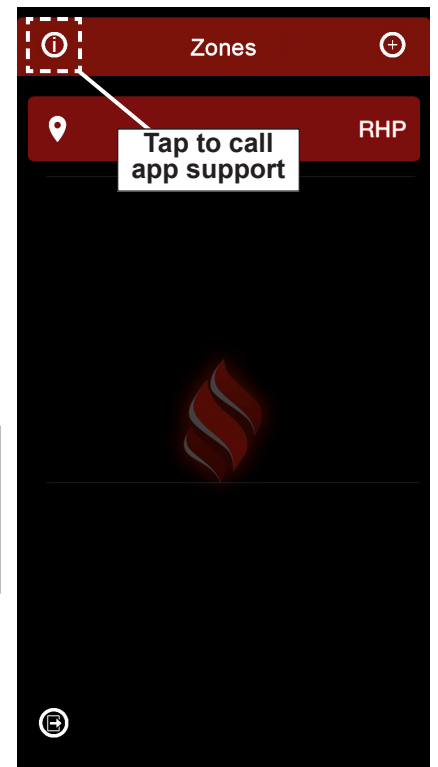

Fig. 12-1 Call support

NOTES

Please use this page to record any information that you may want to have at hand.